

# NCFL 名古屋外語・ホテル・ブライダル専門学校 Nagoya College of Foreign Languages

**Have confidence in yourself and your dreams can come true.**

Do you want to use English every day? What about a profession that is focused on Japanese hospitality and first-class service.

Your dreams can be realized and achieved at the Nagoya College of Foreign Languages.

Being close when dreams come true means (I can) do it too!

See your potential and your effort will be rewarded.

For your bright future, 2-years of running with a smile.

Want a change and discover yourself this school is here for you.

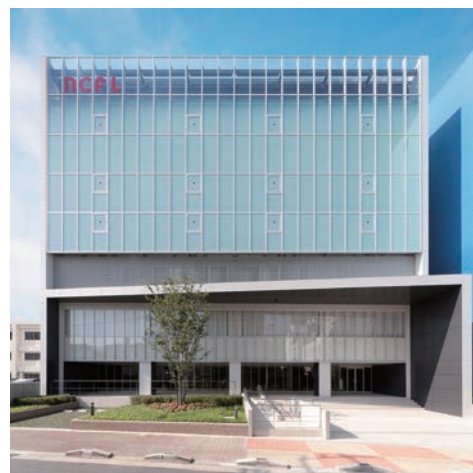

## Learning and support for your 「Dream」

### 1 「Real English」 with an intensive English curriculum

Expert advice on improving your 「real English」 concentrating on the basics 「Reading, Writing, Listening, Speaking」 fundamentals to everyday English with high levels of learning goals. TOEIC and EIKEN Tests and oversees study abroad options and an active approach to learning.

### 3 A 「Homeroom Teacher」 with full support

At our school we have a 「homeroom teacher」 that offers one-on-one support to students with professional experience in their industry and support with knowledgeable staff to complete the total student experience.

### 5 「Study abroad」 Learning a language • understanding hospitality

Language learning and service from the place. Every year oversees study abroad is offered to places like New Mexico State University in America to La Salle University and a cultural experience and foreign invested airline companies with a flight attendant experience in the Philippines. Oversees wedding, foreign invested hotel oversees study abroad and various programs.

### 2 Focused on jobs with 「practical lessons」

At our school professional education is done by professional teachers with an 「active-learning classes」 at the heart. From a real wedding in the chapel to airline, hotel and bridal services from the guests point of view. Learning experiences and facilities to have.

### 4 A winning approach to obtaining useful qualifications

For each major qualification we have special lessons. From interview practice Also Junior College is offered as a double-major so you are able to fill-in Junior College in applying to companies.

### 6 Top level employment rate

15-years strait of graduates becoming flight attendants and that among vocational schools in the Chubu area our school can boast that it has top level achievements in employment.

# Many things to learn and we will support 「your dream」 Department Introductions

At our school 「language learning」 and 「Japanese Hospitality」 lay the basis for our 4 areas of study. In our 「4-Departments」 constant proficiency with useful English with a conscious awareness of the real-world with practical classes and thoroughness in hospitality training. With this knowledge, techniques and with the heart of hospitality we share all of this in our educational training.



With real English training  
From English you just 「know」 to English you 「can use」

## English Department 2-year Curriculum men / women

Real-world English and wide variety of choices in your career guidance!

[Potential Careers • Career Guidance]

Interpreter • Translator / Foreign Related Company Staff  
Trading Company Staff / Tour planner / Flight Attendant  
Travel Agent / International Volunteer / Teach English to Children  
Kids English Teacher / Study Abroad  
University Transfer in Japan and overseas etc.

### Features of this department

- Professions that use English every day and acquire 「English Strength」 as a goal
- Obtain the 「Teach English to Children」 certificate while at school
- In Japan or abroad you can transfer to university and (our school 2-years + university 2-years) become a university graduate
- Do an overseas study abroad and choose the length of program to fit your goals.

Brush up on your language skills and manners  
a career in the airline industry or foreign related company

## International Airline Department 2-year Curriculum women

13-years straight of flight attendants being hired!

[Potential Careers]

Flight Attendant / Airport Staff  
Airport Information Staff / Airport Duty Free Staff  
Foreign Invested Company Staff / International Careers  
Shinkansen Attendant / Sales Staff etc.

### Features of this department

- 13-years straight of a flight attendants being hired. The #1 rated vocational school in actual results in the Chubu area.
- Discover the manners needed in society and become an honest person
- As a student get training experience at the airport and for major airline companies
- How to express yourself and be more attractive strengthen enhance your potential

A real chapel at our school!

Full-support of your dream in the bridal industry

## Bridal Department 2-year Curriculum men / women

Build on experience many are hired by the most challenging companies

[Potential Careers]

Bridal Coordinator / Bridal Producer  
Bridal Stylist / Bridal Announcer  
Flower Coordinator / Bridal Hair Stylist  
Bridal Nail Stylist etc.

### Features of this department

- Acquire and learn everything about the Bridal industry knowledge and techniques (Bridal Coordinator Course)
- Focused on apparel everything about beauty and style (Bridal Stylist Course)
- Full-support and training to obtain the 「ABC Qualification」
- Graduation project 「Wedding ceremony and reception」 at a first-class venue

Learn a language and  
Become a global hotel staff

## International Hotel Department 2-year Curriculum men / women

International hotel employment and top-class results

[Potential Careers]

Front Staff / Door Staff / Bell Staff  
Restaurant Staff / Banquet Staff  
Reservations / Banquet Staff etc.

### Features of this department

- Numerous graduates working at first-class hotels in Japan and overseas! Highly rated vocational school for top-class results in the Chubu area.
- Service from front to the banquet find more about true Japanese hospitality
- Do an internship at first-class hotels As a student learn and experience from professionals
- Perform in Bridal Department' s wedding ceremony and reception and be responsible for service



# Study in Nagoya, Located at the Center of Japan

What's Nagoya like?

Nagoya city is the home of AFLS, situated in Aichi prefecture in the center of Japan. Population: 2.2 million. The city plays an important role in Japan as the hub of the automobile, aviation, and machine tool industries.

Nagoya's long history dates back 1900 years. Nowadays, it's a transportation crossroads including one of the busiest ports in Japan. The city has attractive tourist sites like Nagoya Castle, the Tokugawa Art Museum, the Toyota Museum, and Osu Kannon Temple where the "World Cosplay Summit" is held every year.

Food in Japanese is "Meshi". And "Nagoya Meshi" is excellent. Famous local cuisine like "Misonikomi," "Tebasaki," and "Miso-katsu" is characterized by strong and salty seasonings and an ever expanding fan base. You've got to try some.

International students like Nagoya simply because living expenses are more reasonable than Tokyo or Osaka.

Nagoya is the ideal place to study Japanese. It's just fun.



## To foreign exchange students

[Foreign students tuition will be waived system]

Who can apply: Foreign students from outside Japan on a 「study abroad visa」 who are thinking about applying to our school

The reduced cost: During admission tuition will be reduce by 200,000 yen

During advancement to the 2nd grade if you attendance is above 95% your 2nd year tuition will be reduced by 100,000 yen

## Foreign exchange students Denpa School Group Thank you scholarship program

◎Privilege: A: To have tuition reduced by 200,000 yen the 1st year of your 2nd semester (limited)  
B: To have tuition reduced by 150,000 yen the 1st year of your 2nd semester (limited)

◎Reference: ☆ Written Examination (general knowledge) ☆ Interview

◎Application Deadline and Examination Schedule

☆ Acceptance period: From Tuesday, October 1, 2018 to Friday, January 15, 2019

☆ Examination Date: Saturday, January 26, 2019

◎ For more information please contact our school

## Student Dormitory Guide

There is a student dormitory Heights of school ownership so that the incoming students from afar can study and living in peace.



### Dormitory Meiji [for men]

- Type A 70 rooms per person  
Size: 9.27m<sup>2</sup> / ¥43,800 per month
- Type B 42 rooms per person  
Size: 15.45 m<sup>2</sup> / ¥50,800 per month
- Equipment Canteen, communal bathroom, washing machine, air-conditioner, TV, telephone, Wi-Fi



### Jingu Higashi Student Heights [for women]

- 40 rooms per person  
Size: 10 ~ 10.8 m<sup>2</sup> / ¥39,000 ~ ¥42,000 per month
- Equipment Kitchen, bath room, toilet, refrigerator, desk, chair, Book shelf, bed, air-conditioner



### Student Heights Tenma (tentative name) [for men]

- 54 rooms per person  
Size: 10.6 m<sup>2</sup> / ¥46,000 per month
- Equipment kitchen, bath, toilet, air-conditioner, Wi-Fi



### International students only Dormitory Horita [for men & women]

- 55 rooms per person  
Size: 10.6 m<sup>2</sup> / ¥40,000 per month
- Equipment kitchen, bath, toilet, air-conditioner, Wi-Fi

# School Expenses

Department	Year	Payment Period	Admission Fee	Tuition Fee	Building Fee	School Expenses	Total
English International Airline Airport Business	1st Year	During admission process	200,000	400,000	100,000	50,000	750,000
		September		400,000	100,000		500,000
	2nd Year	March		400,000	100,000	50,000	550,000
		September		400,000	100,000		500,000
Bridal International Hotel	1st Year	During admission process	200,000	450,000	100,000	50,000	800,000
		September		400,000	100,000		500,000
	2nd Year	March		450,000	100,000	50,000	600,000
		September		400,000	100,000		500,000

(Unit : Japanese Yen)

- In addition to the above costs and fees during the admission process an alumni membership fee (admission fee) of 5,000 yen is required.
- The above costs and fees do not include Junior College fees (See below this page)
- Following admission textbook fees and material costs will be required. Depending on the course and electives chosen fees will range from 15,000 yen to 50,000 yen (2018 actual fees and costs).
- During graduation, a graduation fee of 37,000 yen (2018 actual fees and costs) and an alumni membership fee (lifetime membership) is required.
- During enrollment school bonds, donations and such will not be collected.
- Training Costs are for the International Hotel Department' s (hotel tour trips, table manner lessons, cooking lessons and general exercises etc.) and in the Bridal Department' s (wedding goods production, nail art, flower arrangements, creating dresses and general exercises etc.) are special class fees and expenses.
- Recreation day and College festival operating costs etc. are included in school expenses.
- In addition to the above, a study abroad fee for the English Department of approximately 450,000 yen expense (New Mexico State University, Hawaii University etc. language learning study abroad. This includes travel fees, tuition fees and food expenses are included.  
International Airline Department has approximately 300,000 yen expense (oversees airplane company flight attendant training, local university cultural exchange and volunteer etc.  
✳ In principle only 1st year students.  
Airport Business Department has approximately a 200,000 yen expense (oversees airplane company training facility study abroad plan)  
Bridal Department has approximately 300,000 yen to 400,000 yen expense (oversees wedding training, wedding facility tours etc.)  
International Hotel Department has approximately 350,000 yen to 450,000 yen expense (oversees hotel training, hotel facility tours etc.  
✳ The Above study abroad fees are subject to change.
- Before the entrance ceremony a written document stating admission refusal with intention displayed, In principal with the exception of the admission fee the fees and costs paid by the student relating to tuition and alumni membership fee will be returned